

# PS/PSQ™/HST

## Strap Ties

PS/PSQ pile straps are ideal for attaching girders to piles, bringing strength to the connection when the wood members are notched. The PSQ installs faster and easier with the patented Strong-Drive® SDWH™ Timber-Hex HDG screws and offers higher loads. (Screws not included.)

**Finish:** PS/PSQ — HDG; also available in black powder coat (add PC to sku)

HST2 and HST5 — Galvanized

HST3 and HST6 — Simpson Strong-Tie gray paint

**Material:** See table

**Codes:** See p. 13 for Code Reference Key Chart

**Web Applications:** Visit [app.strongtie.com/pbs](http://app.strongtie.com/pbs) to access our Post-to-Beam Selector web application.

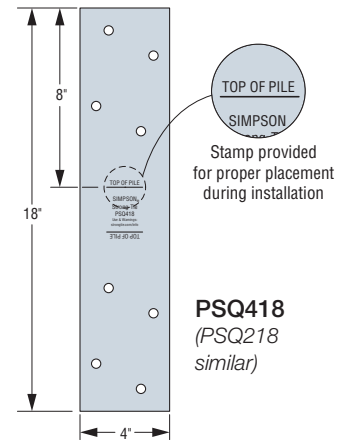
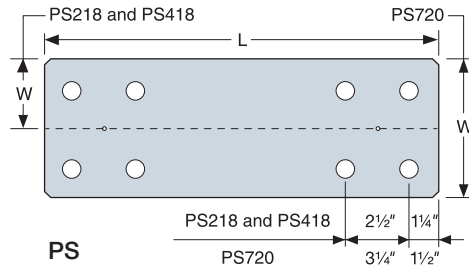

These products are available with additional corrosion protection. For more information, see p. 16.

Model No.	Ga.	Dimensions (in.)		Fasteners (Total)	DF/SP Allowable Tension Loads	SPF/HF Allowable Tension Loads	Code Ref.
		W	L		(160)	(160)	
PS218	7	2	18	(4) 3/4" bolts	1,740	1,385	—
PS418		4	18	(4) 3/4" bolts	1,740	1,385	
PS720		6 3/4	20	(8) 1/2" bolts	3,075	2,645	
PSQ218		2	18	(8) SDWH27400G	2,815	2,420	
PSQ418		4	18	(8) SDWH27400G	3,045	2,620	

- See pp. 276–277 for Straps and Ties General Notes.
- Posts and beams may consist of multiple members provided they are connected independently of the strap fasteners.
- PSQ loads are per part (not pair). F<sub>1</sub> loads on DF/SP for PSQ218 and PSQ418 are 750 lb. and 780 lb., respectively. SPF/HF F<sub>1</sub> loads are 645 lb. and 670 lb.
- PS loads are per part (not pair). Loads are based on perpendicular-to-grain loading in the beam and parallel-to-grain loading in the post and assume a minimum member thickness of 3 1/2". PS straps must be positioned such that bolt end and edge distances meet NDS minimum requirements.
- All references to bolts are for structural-quality through bolts (not lag screws or carriage bolts) equal to or better than ASTM A307, Grade A.
- Screws:** SDWH27400G = 0.27" diameter x 4" long Strong-Drive SDWH Timber-Hex HDG screw. (Longer SDWH27G screws may be used.)

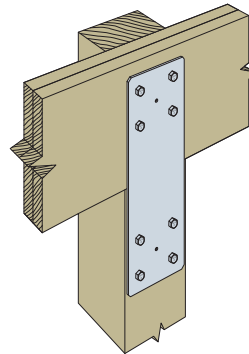

Typical PS720 Installation

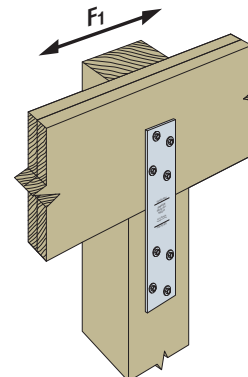

Typical PSQ Installation

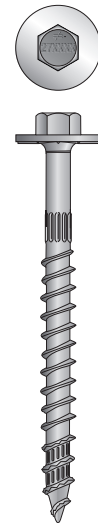

SDWH27400G

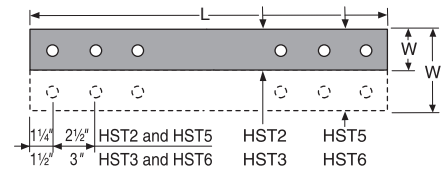

HST

Model No.	Ga.	Dimensions (in.)		Fasteners (in.)		DF/SP Allowable Tension Loads	SPF/HF Allowable Tension Loads	Code Ref.	
		W	L	Nails	Bolts		(160)		(160)
					Qty.	Dia.			
HST2	7	2 1/2	21 1/4	—	6	5/8	5,220	4,835	IBC®, FL, LA
HST5		5	21 1/4	—	12	5/8	10,650	9,870	
HST3	3	3	25 1/2	—	6	3/4	7,650	6,580	
HST6		6	25 1/2	—	12	3/4	15,425	13,265	

- See pp. 276–277 for Straps and Ties General Notes.
- Allowable bolt loads are based on parallel-to-grain loading and these minimum member thicknesses: HST2 and HST5 – 3 1/2"; HST3 and HST6 – 4 1/2".
- All references to bolts are for structural-quality through bolts (not lag screws or carriage bolts) equal to or better than ASTM A307, Grade A.